

NT 48/1

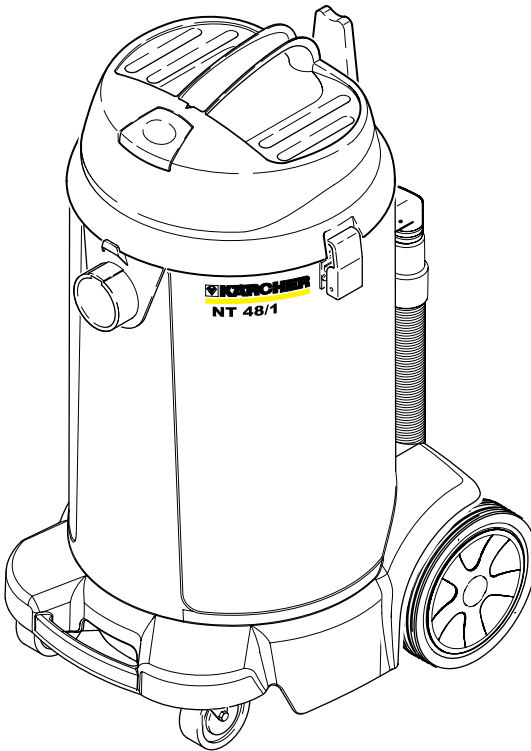

English	3
Français	9
Español	15

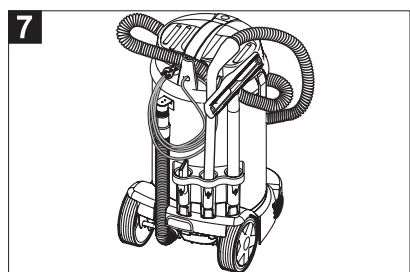

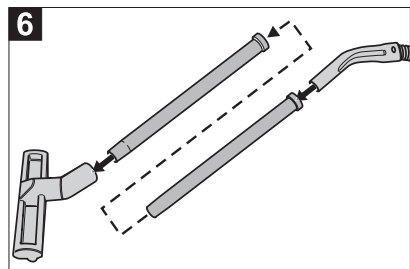
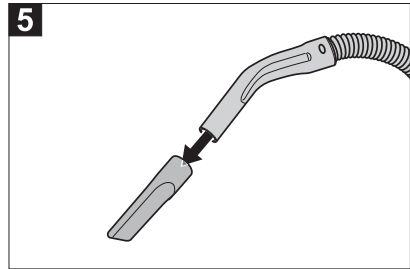
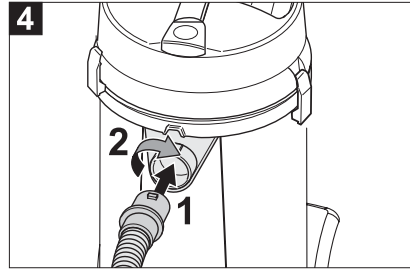
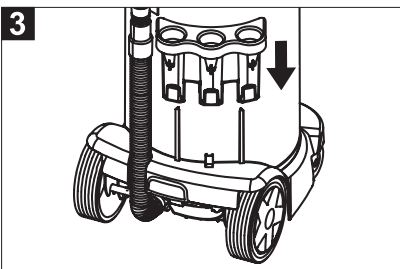
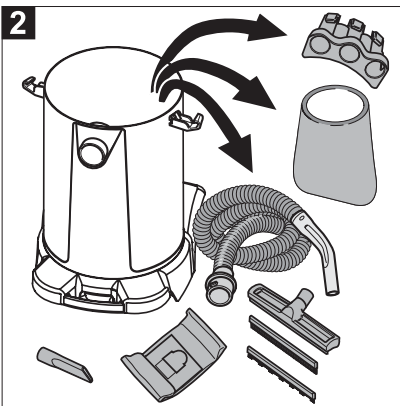
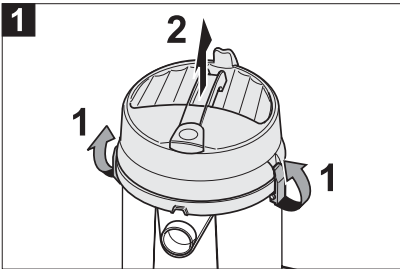
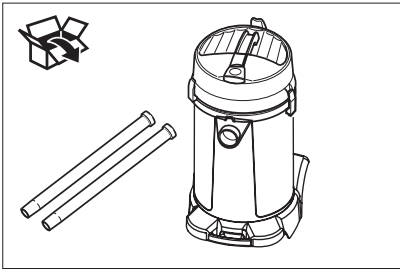

IMPORTANT SAFETY INSTRUCTIONS

READ ALL INSTRUCTIONS BEFORE USING THIS MACHINE.

- Inform your dealer immediately if there is any shipping damage.
- Completely remove the accessories from the box.
- The suction unit is not suitable for sucking up hazardous dusts as asbestos. Please consult your Kärcher branch or your Kärcher dealer with regard to such applications.
- Only operate the vacuum from a grounded outlet. Refer to the Technical data for the necessary main fuse.

When using an electrical machine, basic precautions should always be followed, including the following: This vacuum is intended for commercial use.

- 1 DISCONNECT VACUUM CLEANER FROM POWER CIRCUIT before removing the cover, performing maintenance work, and when not in use.
- 2 DO NOT LEAVE the machine unattended when plugged in.
- 3 ALWAYS CHECK THE POWER SUPPLY CORD for damage or signs of any aging before each use.
- 4 DO NOT PULL OR CARRY VACUUM CLEANER BY CORD. Do not close door on cord or pull cord around sharp edges.
- 5 KEEP CORD AWAY FROM HEAT AND OIL. Do not leave cord lying around after job is complete. It can become a tripping hazard.
- 6 DO NOT RUN VACUUM OVER CORD.
- 7 TURN SWITCH TO OFF before unplugging power supply cord.
- 8 DO NOT UNPLUG BY PULLING CORD. To unplug, grasp plug, not cord.
- 9 DO NOT GRASP PLUG WITH WET HANDS.
- 10 A DAMAGED CORD OR PLUG should only be replaced by an authorized serv-

ice center representative. DO NOT ATTEMPT TO REPAIR POWER CORD.

- 11 TO AVOID SHOCK, do not expose to rain. Store indoors.
- 12 USE ONLY AS RECOMMENDED BY THIS MANUAL. Use only with recommended attachments.
- 13 KEEP HAIR, CLOTHING, LOOSE JEWELRY, FINGERS and all parts of the body away from openings and moving parts.
- 14 DO NOT BLOCK OR OBSTRUCT OPENINGS. Keep openings free of lint, hair, dust, and anything that restricts air flow.
- 15 DO NOT PICK UP ANYTHING THAT IS BURNING, smoldering, or smoking such as matches, cigarettes, or hot ashes.
- 16 DO NOT USE TO VACUUM COMBUSTIBLE EXPLOSIVE MATERIALS, such as coal, grain, and other finely divided combustible material.
- 17 DO NOT USE TO VACUUM COMBUSTIBLE, hazardous, toxic, or carcinogenic materials, including gasoline, diesel fuel, acetone, paint thinner, heating oils, undiluted acids and solvents, pesticide, and asbestos.
- 18 USE RECOMMENDED FILTERS when vacuuming drywall materials.
- 19 DO NOT USE WITHOUT FILTER and/or dust bag in proper place.
- 20 DO NOT ALLOW VACUUM CLEANER TO BE USED AS A TOY. Keep children away from Vacuum Cleaner.
- 21 DO NOT LEAVE UNATTENDED while Vacuum Cleaner is running.
- 22 DO NOT USE IF CORD, PLUG, FILTER, OR VACUUM CLEANER IS IN POOR CONDITION. If the Vacuum Cleaner has been dropped, damaged, exposed to weather, or dropped into water; have it checked by an authorized service .
- 23 ALWAYS USE EYE PROTECTION when operating Vacuum Cleaner.

- 24 USE EXTRA CAUTION when operating on stairs.
- 25 STAY ALERT! Do not use Vacuum Cleaner when you are tired or under the influence of drugs, alcohol or medication.

SAVE THESE INSTRUCTIONS

This vacuum is intended for commercial use.

Servicing of double-insulated machines

In a double-insulated machine, two systems of insulation are provided instead of grounding. No grounding means is provided on a double-insulated machine, nor should a means for grounding be added to the machine. Servicing a double-insulated machine requires extreme care and knowledge of the system, and should be done only by qualified service personnel. Replacement parts for a double-insulated machine must be identical to the parts they replace.



Please read and comply with these instructions prior to the initial operation of your appliance. Retain these operating instructions for future reference or for subsequent possessors.

- Before first start-up it is definitely necessary to read the safety indications Nr. 5.956-249!
- The non-compliance of the operating and safety instructions may lead to damages of the appliance and to dangers for the operator and other persons.
- In case of transport damage inform vendor immediately

Contents

Environmental protection	5
Proper use	5
Start up	5
Operation	7
Shutting down	7
Maintenance and care	7
Troubleshooting	8
Warranty	8
Accessories and Spare Parts	8

Environmental protection



The packaging material can be recycled. Please do not throw the packaging material into household waste; please send it for recycling.



Old appliances contain valuable materials that can be recycled; these should be sent for recycling.. Batteries, oil, and similar substances must not enter the environment. Please dispose of your old appliances using appropriate collection systems.

Proper use

- The machine is meant for dry and wet cleaning of floors and walls.
- This appliance is suited for the commercial use, e.g. in hotels, schools, hospitals, factories, shops, offices, and rental companies.

Start up

Dry vacuum cleaning

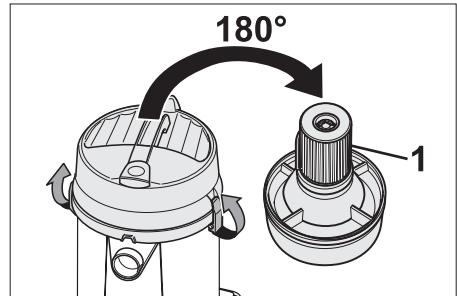

- For sweeping, always fix cartridge filter (1).
- To suck fine dust, you can also use an additional paper filter bag (2).

Inserting the paper filter bag

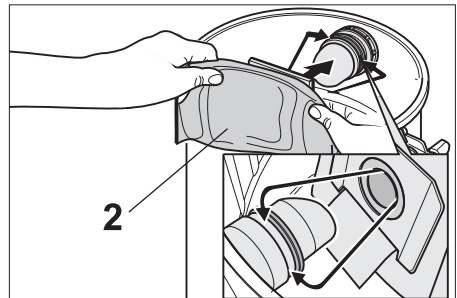

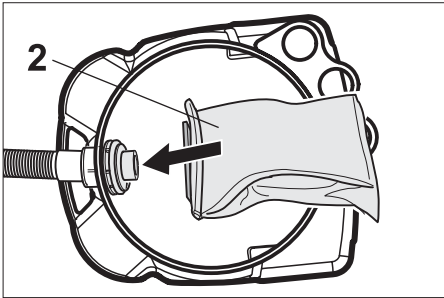

- Release and remove the suction head.
- Insert the paper filter bag (2).
- Insert and lock the suction head.

Wet vacuum cleaning

Inserting the rubber lips

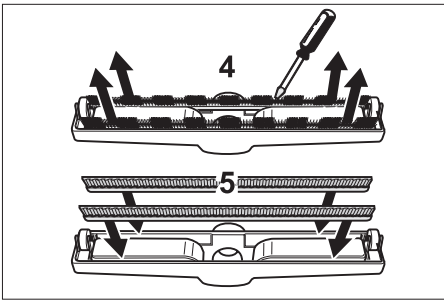

- Remove the brush strips (4).
- Insert the rubber lips (5).

Note

The structured side of the rubber lips must point outwards.

Remove the paper filter bag

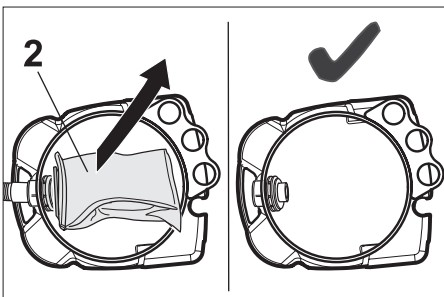

- To suck wet dirt, first remove the paper filter bag (2).

Installing an additional filter

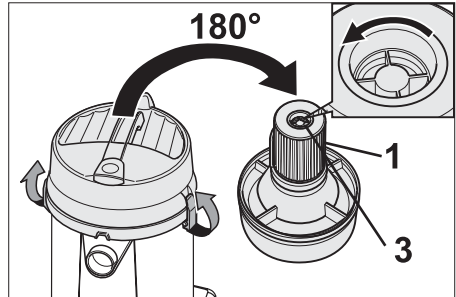

- Release and remove the suction head.
- Turn the suction basket by 180° and keep it aside.
- Loosen nut (3).
- Remove the cartridge filter (1).

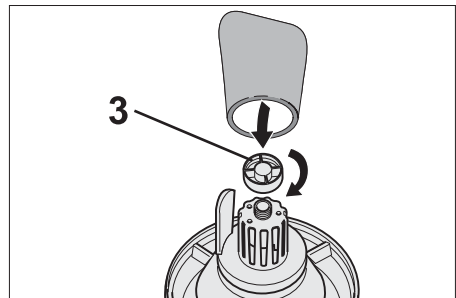

- Insert the nut (3) and tighten it.
- Install the additional filter.
- Insert and lock the suction head.

Clip connection

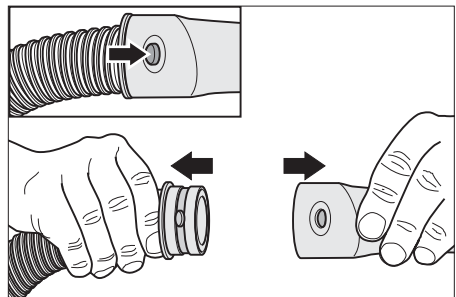

The suction hose is equipped with a clip system. All C-35/C-DN-35 accessories can be connected.

Operation

Turning on the Appliance

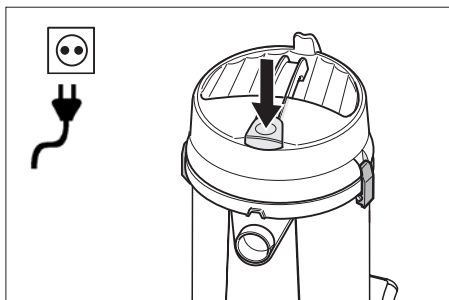

- Plug in the main plug.
- Turn the appliance on and put it into operation.

Emptying the dirt container

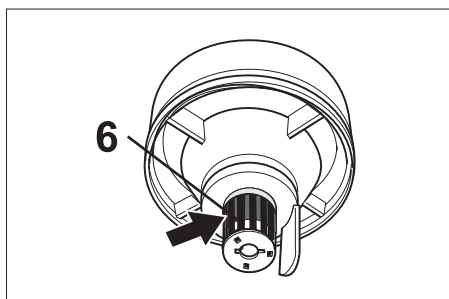

The suction canal (6) is equipped with a float.

- When the dirt water reaches the highest permissible level in the container, the suction power is interrupted.
- Turn off the appliance.

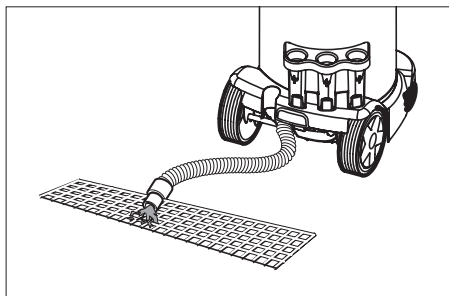

- Empty the dirt container.

Drain off dirty water through the drainage hose.

Shutting down

- Empty the dirt container.
- Vacuum and wipe the appliance inside and outside.
- Place the appliance in a dry room and secure it from unauthorized use.

Maintenance and care

⚠ Warning

First remove the mains plug before doing any job on the vacuum cleaner.

Change cartridge filter

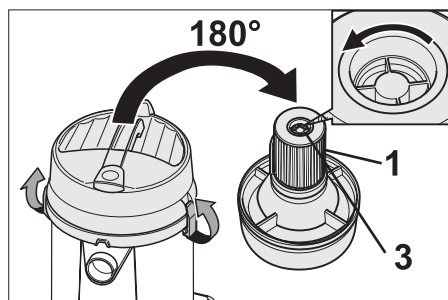

- Release and remove the suction head.
- Turn the suction basket by 180° and keep it aside.
- Loosen nut (3).
- Remove the cartridge filter (1).

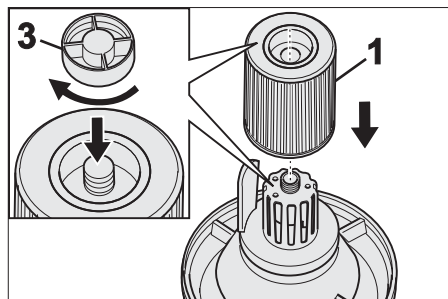

- Insert the new cartridge filter (1).
- Insert the nut (3) and tighten it.
- Insert and lock the suction head.

Troubleshooting

Suction turbine does not run

- Check cables, plugs, fuse, and socket.
- Turn on the appliance.

Vaccum turbine is running but the machine is not sucking in dust/dirt

- Float is blocking the suction canal.
- Empty the dirt container.

Suction capacity decreases

- Remove choking of suction nozzle, suction tube, suction hose, or cartridge filter.
- Exchange the paper filter bag.
- Change cartridge filter.

Dust comes out while vacuuming

- Check the proper installation of the cartridge filter.
- Change cartridge filter.

Warranty

The warranty terms published by our competent sales company are applicable in each country. We will repair potential failures of your appliance within the warranty period free of charge, provided that such failure is caused by faulty material or defects in fabrication. In the event of a warranty claim please contact your dealer or the nearest authorized Customer Service center. Please submit the proof of purchase.

Accessories and Spare Parts

- Only use accessories and spare parts which have been approved by the manufacturer. The exclusive use of original accessories and original spare parts ensures that the appliance can be operated safely and troublefree.
- At the end of the operating instructions you will find a selected list of spare parts that are often required.

- For additional information about spare parts, please go to the Service section at www.kaercher.com.



120 V
1~ 60 Hz

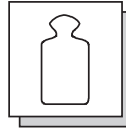

23.1 lbs (10.5 kg)



SJTW-A 2/16 AWG
6.648-370.0
25 ft (7.5 m)

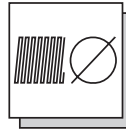

C-DN / C-ID
1.38 in (35 mm)



72 dB(A)

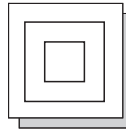

II

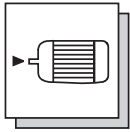

I nom: 10 A

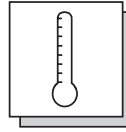

max. 104 °F (+40 °C)
Umgebungstemperatur,
Ambient temperature,
Température ambiante

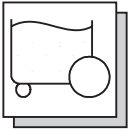

12.7 gal (48 l)

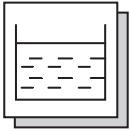

9.2 gal (35 l)

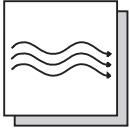

max. 142 CFM (67 l/s)

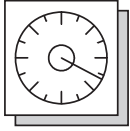

max. 2000 mm (19.6 kPa)

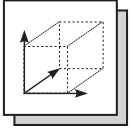

19.5 in x 15.5 in x 30.5 in
(490 mm x 390 mm x
780 mm)

